

Date **January, 2011** Price (UF) **\$649,000**  
 Area **Naushop** Address **37 Goldfinch Drive**  
 Map/Parcel **68/546** Zoning **R5**  
 Legal Owner **TruCap REO Corp.**  
 Rooms **7** BR **4** BA **3** 1/2 BA **1**  
 Outside Shwr **No** Water **Town** Sewer **Town**  
 Year **1994** Condition **Good** Lot Size **.14 Acres**  
 Deed **DOC 48602** Plan **LC 16514** Lot # **238**  
 Attic **Eave storage** Basement **Full**



Property Description:

**First floor:** *Living room, kitchen and dining area leading to a large back yard through a sliding glass door, powder room, den, laundry room.*

**Second floor:** *Master bedroom with full bath (shower), two guest bedrooms with shared bath (tub/shower).*

**Third floor:** *Large bedroom with full bath (shower).*

Deck/Porch/Patio **Patio** Yard **Yes** Garage **No** Parking **2** Views **Residential** Insulation **Yes**  
 Storms/Screens **Partial Screens** Heat **GFHW** DHW **Gas** UFFI **No** Foundation **Poured** Lead Paint **No**  
 Floors **Pergo/hardwood/linoleum** Fireplace(s) **No** Appliances (E/G): **S Gas R No DW Yes Disp No**  
 Washer **Yes** Dryer (E/G) **Yes** CATV **Yes** A/C **No** Irrigation **Yes** Other **Garden shed**  
 2011 Assessments: Land **\$332,100** Buildings **\$354,300** Total **\$686,400** 2011 Taxes **\$2,457.31**

Easements/Restriction/Covenants/Condominium: **Subject to Naushop protective covenants and annual Homeowner's fees. Utility and drainage easements.**

Comments: **Excellent opportunity in a lovely area of Naushop. Three floors of living space in this four bedroom, three and a half bath home. Large private back yard.**

Atlantic East Nantucket Listing agent is: **Ginger Ivey**

*Information contained herein is believed to be reliable but is not guaranteed*



**Atlantic East**  
**NANTUCKET REAL ESTATE**

**508-228-7707**

5 North Water Street  
 Nantucket, MA 02554  
[www.NantucketRealEstate.com](http://www.NantucketRealEstate.com)



ZONING CLASSIFICATION: *RC-Z* EXISTING:  
 MIN. AREA: 5000 S.F. 6141 ± S.F.  
 MIN. FRONTAGE: 40 FT. SEE PLAN  
 FRONT YARD S.B.: 20 FT.  
 REAR & SIDE S. B.: 5 FT.  
 GROUND COVER (%): 50% 15% ±

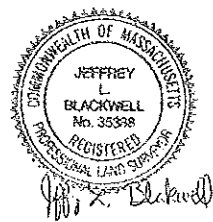
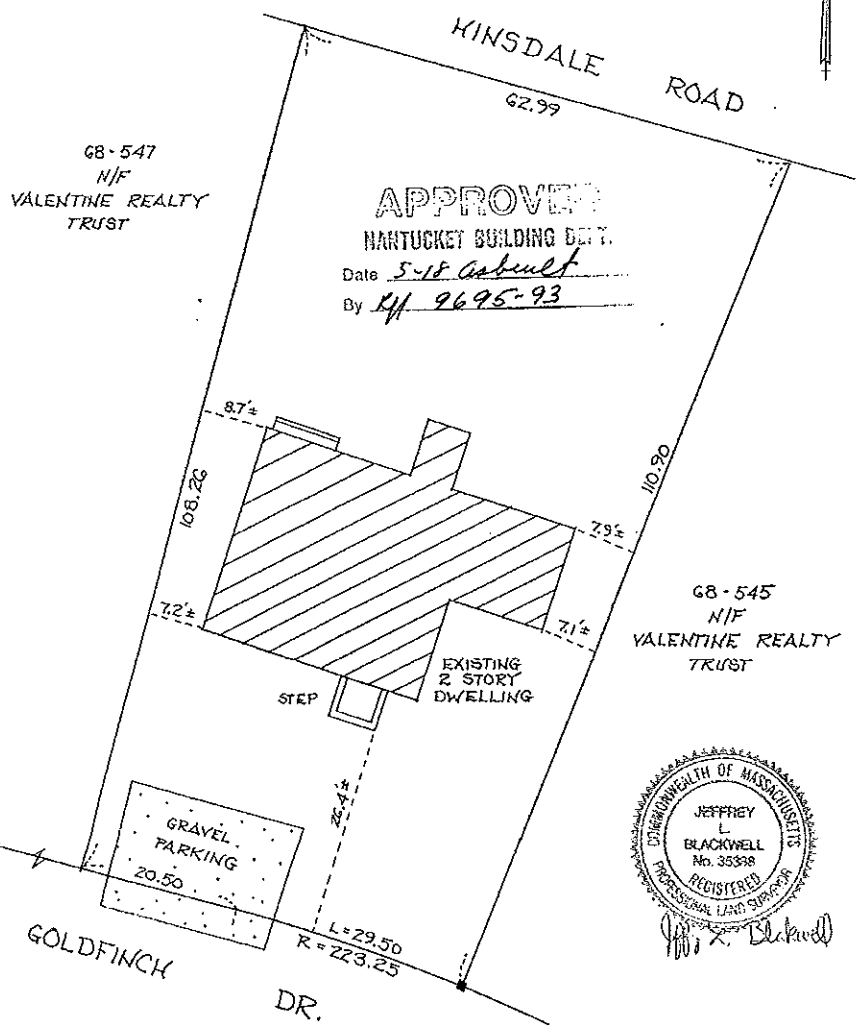

I CERTIFY, AS OF *5-10-93*, THAT THE BUILDING(S) IS/ARE LOCATED ON THE GROUND AS SHOWN HEREON.  
 Jeffrey L. Blackwell  
 PROFESSIONAL LAND SURVEYOR

**BUILDING LOCATION PLAN  
 OF LAND IN  
 NANTUCKET, MASS.**

SCALE: 1" = 15' DATE: MAY 11, 1993  
 Owner: BART M. & PAMELA A. GANGEMI LOT 238  
 Deed: DOC. 48602 Plan: LC 12514-12  
 Locust: #37 GOLDFINCH DRIVE

**BLACKWELL & ASSOCIATES, Inc.**  
 6 YOUNGS WAY  
 NANTUCKET, MASS. 02554  
 (508) 228-9026

ASSESSOR MAP: 68 PARCEL: 546 NOT TO BE RECORDED. B-3739